

Addendum No. E-1
To Mechanical & Electrical Plans and Specifications:
Wagner Hangar
Wagner, South Dakota

Addendum Dated: June 21, 2019

Original Plans & Specifications Dated: May 31, 2019

SCOPE OF THIS ADDENDUM: The following becomes a part of the original plans and specifications, taking precedence over the items that may conflict. The bidder shall note receipt and make acknowledgement of the addendum on his bid form, incorporating its provision in his bid.

PLAN AND SPECIFICATION CHANGES AND CLARIFICATIONS:

1. Clarification - See attached MESD-1 for meter location.
2. Change to feeder sizes – sheet E4 – feeder note #1 is “2-1/2 inch conduit with (3) 250 AL.”
3. Change to feeder sizes – sheet E4 – feeder note #5, the meter socket is provided by the utility company.

APPROVED EQUALS:

The following list of equipment manufacturers shall be added to the approved equals listed on the plan sheet schedules, and considered as approved equals subject to meeting all requirements of the plans and specifications – final acceptance subject to shop drawing approval.

1. NA

Blake Woodward, P.E.
Mettler Sichmeller Engineering
(605) 225-4344

Attachments: MESD-1

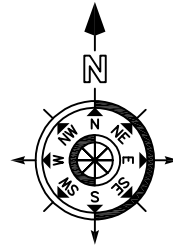
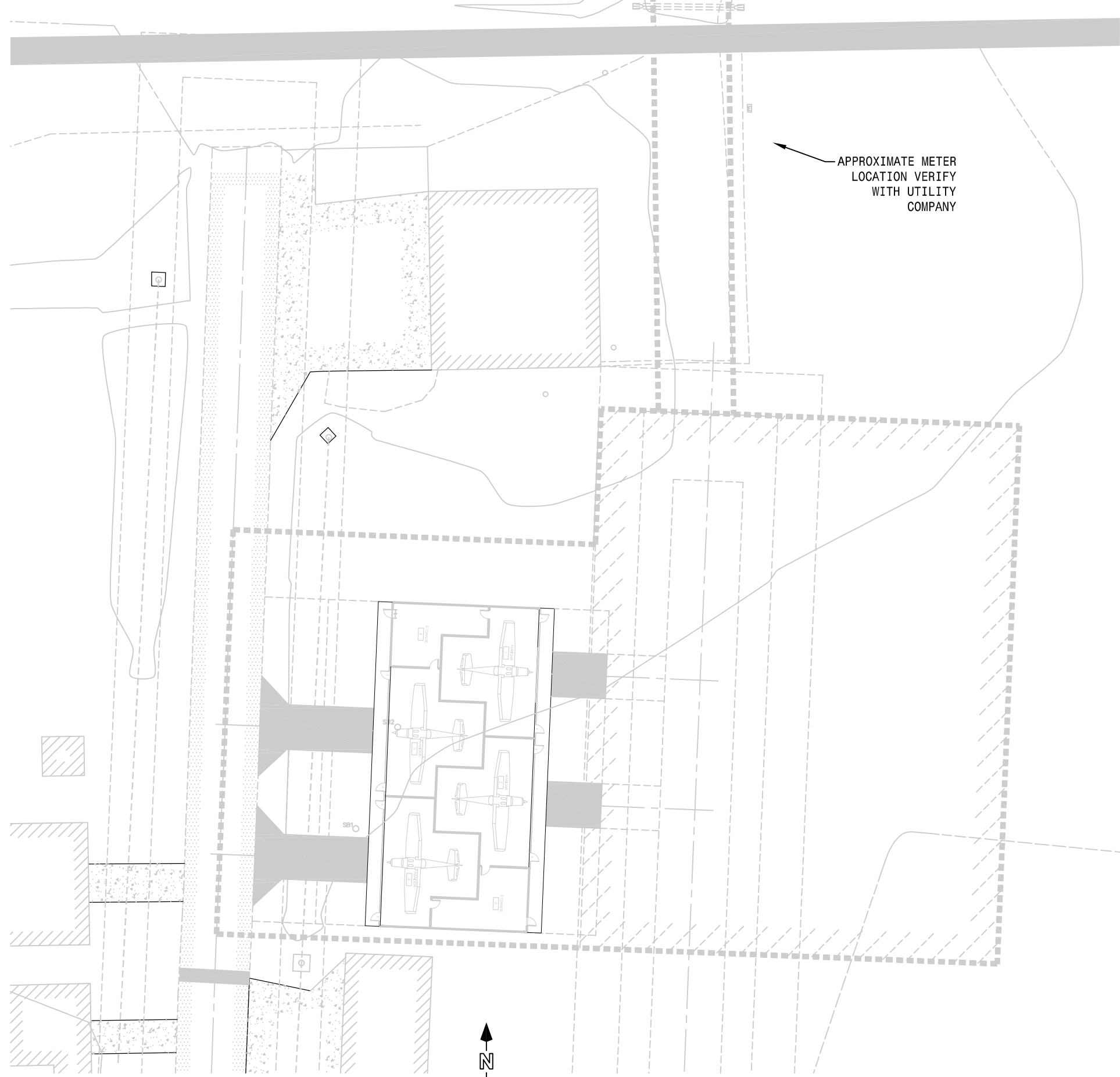

METER LOCATION

Scale: 1" = 40'-0"

APPROXIMATE METER
LOCATION VERIFY
WITH UTILITY
COMPANY

**METTLER
SICHMELLER
ENGINEERING**

Electrical and Mechanical Engineering

**SUPPLEMENTAL
DRAWING
MESD-1**

**WAGNER HANGAR
WAGNER, SD**

REVISED DATE

-

CERT. NO.

C-1257

DRAWN BY **JM**

TRACED BY -

CHECKED BY **BW**

DATE

06/21/19

1
OF-1

PROJECT NO.

181100621E

801 Railroad Ave. SE, Aberdeen, S.D. / Phone: 605-225-4344 / Fax: 605-225-8706